

Electromagnetic Locking Solutions



Z Series Single Non Monitored ELM	58
Z Series Single Monitored ELM	60
Z Series Double Non Monitored ELM	62
Z Series Double Monitored ELM	64
Z Series Recessed ELM	66
Z Series Weather Resistant ELM	68
Accessories	70
Wall Mounted Hold Open Magnet	72
Floor Mounted Hold Open Magnet	73

Z Series Single Non Monitored Electromagnetic Locks

General Description

The Single Series Electromagnetic Locks operate with holding forces from 250kg up to 580kg. Covering a range of applications the Z4 and Z8 Electromagnets are ideal for applications from standard doors through to high use commercial swing doors.

With fixing options including wood, aluminium and steel constructions, as well as glass door applications, the range caters to most electromagnetic needs.

Key Features

- Fail-safe: unlocks when power is removed
- Easy installation: suitable for both new and retrofit usage
- High holding force: refer to the technical data overleaf
- Self-alignment: armature plate pivots to accommodate door drop
- Silent operation: no humming or buzzing
- Dual voltage: site selectable 12 or 24 Vdc
- Instantaneous Release: smart electronics on the Z Series Electromagnets eliminate residual magnetism

Applications

- Aluminium doors
- Glass doors
- IT Storage rooms
- Access control
- Surface mount for inswing and outswing doors



Z4 Electromagnetic Lock - Non Monitored



Z8 Electromagnetic Lock - Non Monitored

Standards and Compliance



Successfully fire rated up to 4hrs on fire door assemblies in accordance with AS1905.1. 2005 (Part 1: Fire resistant door sets)



CE Approved



C-Tick Certified

Z Series Single Non Monitored Electromagnetic Locks

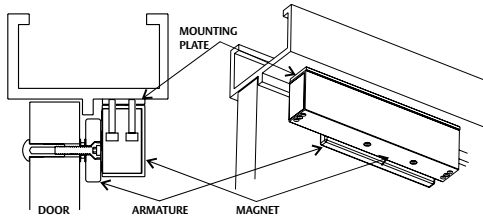

Typical Install for Z4 & Z8 out swinging doors.

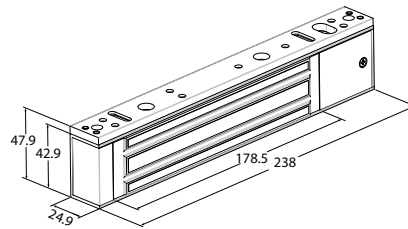

Z4 Electromagnetic Lock

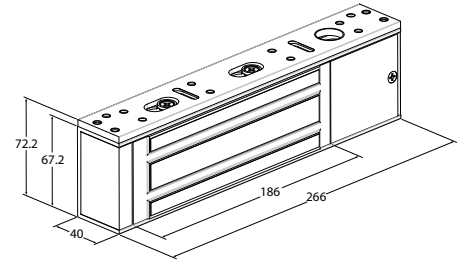

Z8 Electromagnetic Lock

Single Series Technical Information

	Z4 Magnet	Z8 Magnet
Holding Force*	250kg – 280kg	550kg – 580kg
Dimensions	(L)238 x (H)48 x (D)27 mm	(L)266 x (H)72 x (D)40 mm
Voltage	12Vdc/ 24Vdc $\pm 10\%$	12Vdc/ 24Vdc $\pm 10\%$
Current	450mA @ (12Vdc) 225mA @ (24Vdc)	512mA @ (12Vdc) 256mA @ (24Vdc)
Monitoring	None	None
Operating Temperature	-10 to 55 Degrees	-10 to 55 Degrees
Operating Humidity	0 - 95%	0 - 95%

Holding force is measured directly between armature and magnet, holding force on the door may vary depending on the leverage created.

Specification Statement

The Single Series Electromagnetic Lock should be constructed in an aluminium case with heavy duty electromagnet. The range only operates in fail safe mode and relies on a secondary lock or battery backup system. In some cases the magnet armature plate pivots to accommodate door drop. The lock needs to be equipped with “smart electronics” that have zero residual magnetism, (instantaneous release). This is crucial for correct operation.

Ordering Information

Product Description	Part Number
Z4 Electromagnet - Non Monitored	770300-000
Z8 Electromagnet - Non Monitored	770600-000
Accessories	
Z4 L and Z Brackets	770300-901
Z8 L and Z Brackets	770600-901
Z4 Glass Door Brackets	770300-905
Z8 Glass Door Brackets	770600-905
Z4 Armature Bracket non Monitored	770300-909
Z8 Armature Bracket non Monitored	770600-956
Z4 Screw Kit	770300-913
Z8 Screw Kit	770600-950
Z4 Pc Board (Non Monitored)	770300-914

Z Series Single Monitored Electromagnetic Locks

General Description

The Single Series Electromagnetic Locks operate with holding forces from 250kg up to 580kg. Covering a range of applications the Z4 and Z8 Electromagnets are ideal for applications from standard doors through to high use commercial swing doors.

With fixing options including wood, aluminium and steel constructions, as well as glass door applications, the range caters to most electromagnetic needs.

Key Features

- Fail-safe: unlocks when power is removed
- Easy installation: suitable for both new and retrofit usage
- High holding force: refer to the technical data overleaf
- Self-alignment: armature plate pivots to accommodate door drop
- Silent operation: no humming or buzzing
- Dual voltage: site selectable 12 or 24 Vdc
- Monitoring: Reed Switch monitoring on all models. Hall-Effect monitoring on Z4 and Z8 models.
- Instantaneous release: smart electronics on the Z Series Electromagnets eliminate residual magnetism

Monitoring

Hall / Bond Monitoring

This indicates that the lock is powered and that the armature plate is in position and magnetically bonded (it monitors if the magnet is locked)

Reed switch monitoring

An integrated reed switch monitors the door position separately (it monitors the position of the door)

Applications

- Aluminium doors
- Glass doors
- IT Storage rooms
- Access control
- Surface mount for inswing and outswing doors



Z4 Electromagnetic Lock - Monitored



Z8 Electromagnetic Lock - Monitored

Standards and Compliance



Successfully fire rated up to 4hrs on fire door assemblies in accordance with AS1905.1. 2005 (Part 1: Fire resistant door sets)



CE Approved



C-Tick Certified

Z Series Single Monitored Electromagnetic Locks

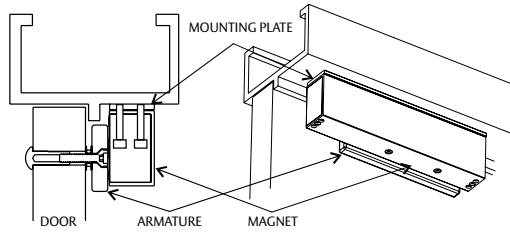

Typical Install for Z4 & Z8 out swinging doors.

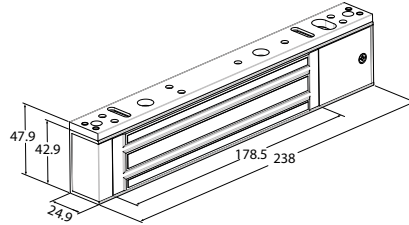

Z4 Electromagnetic Lock

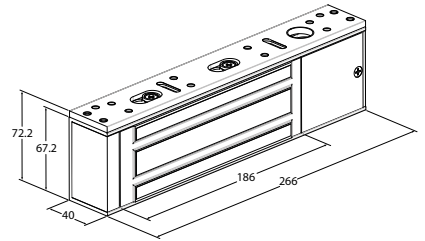

Z8 Electromagnetic Lock

Single Series Technical Information

	Z4 Magnet	Z8 Magnet
Holding Force*	250kg – 280kg	550kg – 580kg
Dimensions	(L)238 x (H)48 x (D)27 mm	(L)266 x (H)72 x (D)40 mm
Voltage	12Vdc/ 24Vdc $\pm 10\%$	12Vdc/ 24Vdc $\pm 10\%$
Current	450mA @ (12Vdc) 225mA @ (24Vdc)	512mA @ (12Vdc) 256mA @ (24Vdc)
Monitoring	Hall-Effect/Bond sensing & Reed Switch	Hall-Effect/Bond sensing & Reed Switch
Operating Temperature	-10 to 55 Degrees	-10 to 55 Degrees
Operating Humidity	0 - 95%	0 - 95%

Holding force is measured directly between armature and magnet, holding force on the door may vary depending on the leverage created.

Specification Statement

The Single Series Electromagnetic Lock should be constructed in an aluminium case with heavy duty electromagnet. The range only operates in fail safe mode and relies on a secondary lock or battery backup system. In some cases the magnet armature plate pivots to accommodate door drop. The lock needs to be equipped with “smart electronics” that have zero residual magnetism, (instantaneous release). This is crucial for correct operation.

Ordering Information

Product Description	Part Number
Z4 Electromagnet - Monitored	770300-012
Z8 Electromagnet - Monitored	770600-012
Accessories	
Z4 L and Z Brackets	770300-901
Z8 L and Z Brackets	770600-901
Z4 Glass Door Brackets	770300-905
Z8 Glass Door Brackets	770600-905
Z4 Armature Bracket Monitored	770300-910
Z8 Armature Bracket Monitored	770600-955
Z4 Screw Kit	770300-913
Z8 Screw Kit	770600-950
Z4 Pc Board (Monitored)	770300-915
Z8 Pc Board (Non Monitored)	770600-013
Z4 Mounting Plate	770300-912

Z Series Double Non Monitored Electromagnetic Lock



Z4 Double Electromagnetic Lock - Non Monitored



Z8 Double Electromagnetic Lock - Non Monitored

General Description

The Double Series Electromagnetic Locks operate with holding forces from 500kg up to 1160kg. Covering a range of applications these magnets are ideal for applications from access ways through to high use commercial swing doors. With fixing options including wood, aluminium and steel constructions, as well as glass door applications, the range caters to most electromagnetic needs.

Key Features

- Fail-safe: unlocks when power is removed
- Easy installation: suitable for both new and retrofit usage
- High holding force: refer to the technical data overleaf
- Self-alignment: armature plate pivots to accommodate door drop
- Silent operation: no humming or buzzing
- Dual voltage: site selectable 12 or 24 Vdc
- Instantaneous release: smart electronics on the electromagnets eliminate residual magnetism.

Applications

- Aluminium doors
- Double swing doors
- Access control
- Surface mount for inswing and outswing doors

Standards and Compliance



Successfully fire rated up to 4hrs on fire door assemblies in accordance with AS1905.1.2005 (Part 1: Fire resistant door sets)



CE Approved



C-Tick Certified

Z Series Double Non Monitored Electromagnetic Lock

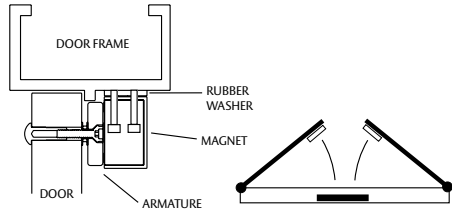

Out swinging door using the standard mounting plate.

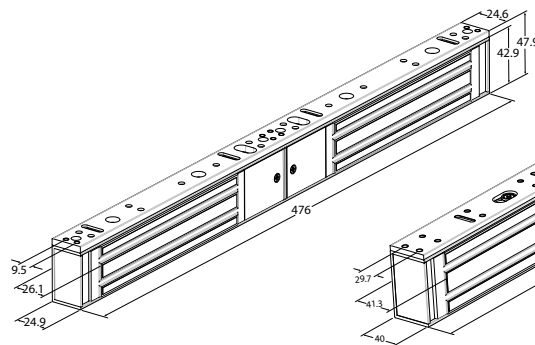

Z4 Electromagnetic Lock

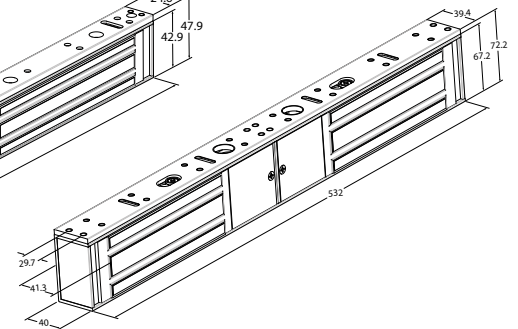

Z8 Electromagnetic Lock

Double Series Non Monitored

	Z4 Magnet	Z8 Magnet
Holding Force	500kg – 560kg	1100kg – 1160kg
Dimensions	(L)476 x (H)48 x (D)27 mm	(L)532 x (H)72 x (D)40 mm
Voltage	12Vdc/ 24Vdc $\pm 10\%$	12Vdc/ 24Vdc $\pm 10\%$
Current	900mA @ 12Vdc 450mA @ 24Vdc	1024mA @ 12Vdc 512mA @ (12Vdc)
Monitoring	None	None
Operating Temperature	-10 to 55 Degrees	-10 to 55 Degrees
Operating Humidity	0 - 95%	0 - 95%

Specification Statement

The Double Series Electromagnetic Lock should be constructed in an aluminium case with heavy duty electromagnet. The range only operates in fail safe mode and relies on a secondary lock or battery backup system. The lock needs to be equipped with “smart electronics” that have zero residual magnetism, (instantaneous release). This is crucial for correct operation.

Ordering Information

Product Description	Part Number
Z4 Double Electromagnet – Non Monitored	770300-100
Z8 Double Electromagnet – Non Monitored	770600-100
Accessories	
Z4D L and Z Brackets	770300-902
Z8D L and Z Brackets	770600-902
Z4 Glass Door Brackets	770300-905
Z8 Glass Door Brackets	770600-905
Z4 Armature Bracket non Monitored	770300-909
Z8 Armature Bracket non Monitored	770600-956
Z4 Screw Kit	770300-913
Z8 Screw Kit	770600-950
Z4 Pc Board (Non Monitored)	770300-914

Z Series Double Monitored Electromagnetic Lock



Z4 Double Electromagnetic Lock - Monitored



Z8 Double Electromagnetic Lock - Monitored

General Description

The Double Series Electromagnetic Locks operate with holding forces from 500kg up to 1160kg. Covering a range of applications these magnets are ideal for applications from access ways through to high use commercial swing doors. With fixing options including wood, aluminium and steel constructions, as well as glass door applications, the range caters to most electromagnetic needs.

Key Features

- Fail-safe: unlocks when power is removed
- Easy installation: suitable for both new and retrofit usage
- High holding force: refer to the technical data overleaf
- Self-alignment: armature plate pivots to accommodate door drop
- Silent operation: no humming or buzzing
- Dual voltage: site selectable 12 or 24 Vdc
- Monitoring: Hall-Effect and Reed Switch monitoring on all models
- Instantaneous release: Smart electronics on the Z Series electromagnets eliminate residual magnetism.

Applications

- Aluminium doors
- Double swing doors
- Access control
- Surface mount for inswing and outswing doors

Monitoring

Hall / Bond Monitoring

This indicates that the lock is powered and that the armature plate is in position and magnetically bonded (it monitors if the magnet is locked)

Reed switch monitoring

An integrated reed switch monitors the door position separately (it monitors the position of the door)

Standards and Compliance



Successfully fire rated up to 4hrs on fire door assemblies in accordance with AS1905.1. 2005 (Part 1: Fire resistant door sets)



CE Approved



C-Tick Certified

Z Series Double Monitored Electromagnetic Lock

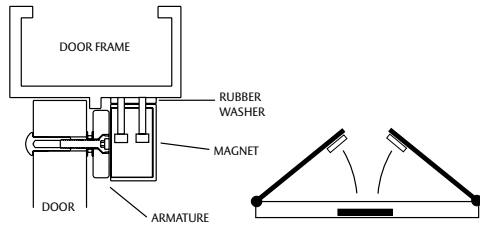

Out swinging door using the standard mounting plate.

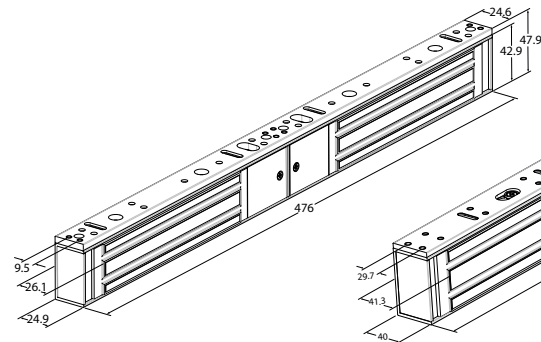

Z4 Electromagnetic Lock

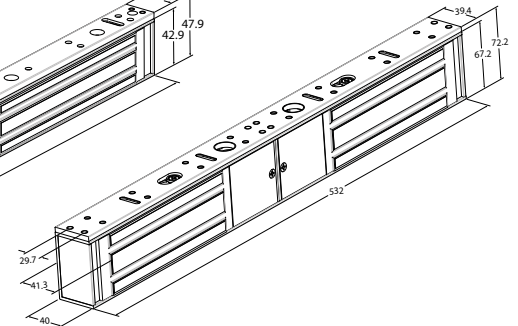

Z8 Electromagnetic Lock

Double Series Monitored Technical Information

	Z4 Magnet	Z8 Magnet
Holding Force*	500kg – 560kg	1100kg – 1160kg
Dimensions	(L)476 x (H)48 x (D)27 mm	(L)532 x (H)72 x (D)40 mm
Voltage	12Vdc/ 24Vdc $\pm 10\%$	12Vdc/ 24Vdc $\pm 10\%$
Current	900mA @ 12Vdc 450mA @ 24Vdc	1024mA @ 12Vdc 512mA @ (24Vdc)
Monitoring	Hall-Effect/Bond sensing Reed Switch	Hall-Effect/Bond sensing Reed Switch
Operating Temperature	-10 to 55 Degrees	-10 to 55 Degrees
Operating Humidity	0 - 95%	0 - 95%

Holding force is measured directly between armature and magnet, holding force on the door may vary depending on the leverage created.

Specification Statement

The Double Series Electromagnetic Lock should be constructed in an aluminium base with heavy duty electromagnetic. The range only operates in fail safe mode and relies on a secondary lock or battery backup system. The lock needs to be equipped with “smart electronics” that have zero residual magnetism, (instantaneous release). This is crucial for correct operation.

Ordering Information

Product Description	Part Number
Z4 Double Electromagnet – Monitored	770300-112
Z8 Double Electromagnet – Monitored	770600-112
Accessories	
Z4D L and Z Brackets	770300-902
Z8D L and Z Brackets	770600-902
Z4 Glass Door Brackets	770300-905
Z8 Glass Door Brackets	770600-905
Z4 Armature Bracket Monitored	770300-910
Z8 Armature Bracket Monitored	770600-955
Z4 Screw Kit	770300-913
Z8 Screw Kit	770600-950
Z4 Pc Board (Monitored)	770300-915
Z8 Pc Board (Monitored)	770600-013

Z4 Recessed Electromagnetic Locks

General Description

The Z4 Recessed Electromagnetic Locks operate with holding forces up to 280kg. Covering a range of applications these magnets are ideal for situations where the magnet needs to be recessed such as swing and sliding doors. With fixing options including wood, aluminium and steel constructions, the range caters to most needs. The Electromagnets are available in both Monitored and Non Monitored models, using Hall-Effect monitoring on some models.

Key Features

- Fail-safe: unlocks when power is removed
- Easy installation: suitable for both new and retrofit usage
- High holding force: refer to the technical data overleaf
- Self-alignment: armature plate pivots to accommodate door drop
- Silent operation: no humming or buzzing
- Dual voltage: site selectable 12 or 24 Vdc
- Monitored versions: Hall-Effect status monitoring available on some models

Applications

- Various sliding door applications

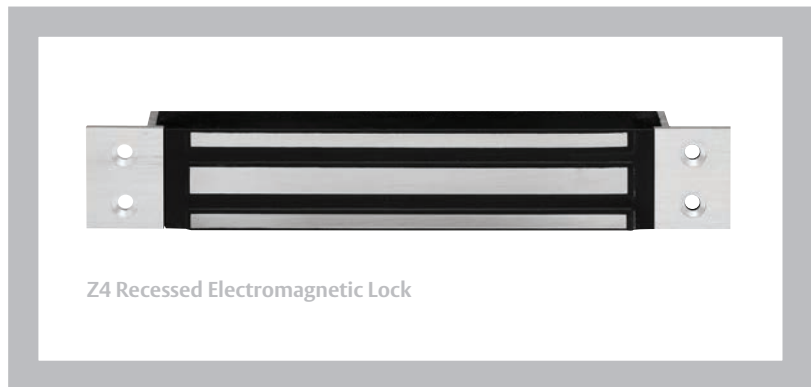

Standards and Compliance



CE Approved



C-Tick Certified

Z4 Recessed Electromagnetic Locks

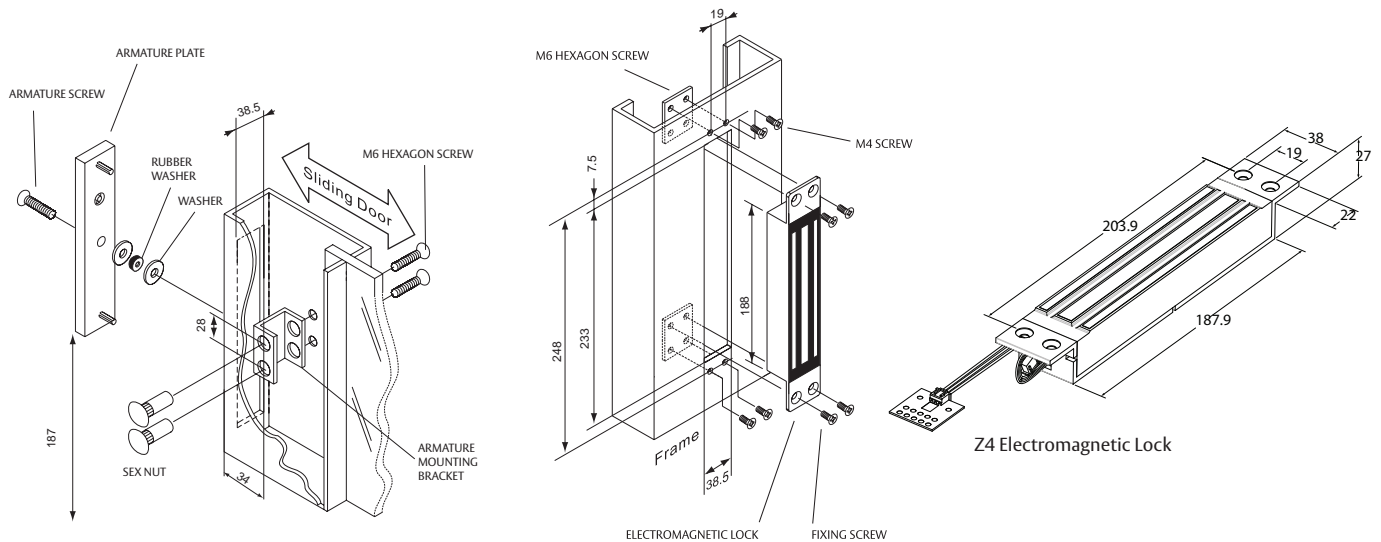

Z4 Recessed Series Technical Information

	Z4 Magnet Non Monitored	Z4 Magnet Monitored
Holding Force	250kg – 280kg	250kg – 280kg
Dimensions	(L)182 x (H)42 x (D)23 mm	(L)182 x (H)42 x (D)23 mm
Voltage	12Vdc/ 24Vdc $\pm 10\%$	12Vdc/ 24Vdc $\pm 10\%$
Current	450mA @ 12Vdc 225mA @ 24Vdc	450mA @ 12Vdc 225mA @ 24Vdc
Monitoring	None	Hall-Effect/Bond sensing
Operating Temperature	-10 to 55 Degrees	-10 to 55 Degrees
Operating Humidity	0 - 95%	0 - 95%

Specification Statement

The Recessed Series Electromagnetic Lock should be constructed in an aluminium case with heavy duty electromagnet. The range only operates in fail safe mode and relies on a secondary lock or battery backup system.

Ordering Information

Product Description	Part Number
Z4 Recessed Electromagnet – Non Monitored	770300-200
Z4 Recessed Electromagnet – Monitored	770300-210

Weather Resistant Electromagnetic Locks

General Description

The Z8 weather Resistant Electromagnetic Lock operates with holding a force up to 580kg. Covering a range of applications this magnet is ideal for applications where it is exposed to the weather. With fixing options including wood, aluminium and steel constructions, the range caters to most external needs. The Electromagnet is available in monitored models using Hall-Effect monitoring. An additional advantage is the ability to select either 12V or 24V DC application on site.

Key Features

- Fail-safe: unlocks when power is removed
- Easy installation: suitable for both new and retrofit usage
- Self-alignment: armature plate pivots to accommodate door drop
- Silent operation: no humming or buzzing
- Dual voltage: site selectable 12 or 24 Vdc
- Monitored versions: Hall-Effect status monitoring available

Monitoring

Hall / Bond Monitoring

Hall Effect position sensors are non-contact devices that convert energy from a magnetic field into an electrical signal. This indicates that the lock is powered and that the armature plate is in position and magnetically bonded (it monitors if the magnet is locked)

Applications

- Outdoor / Exposed doors
- Doors located in coastal areas



Z8 Weather Resistant Electromagnetic Lock - Monitored

Standards and Compliance



CE Approved



C-Tick Certified

Weather Resistant Electromagnetic Locks

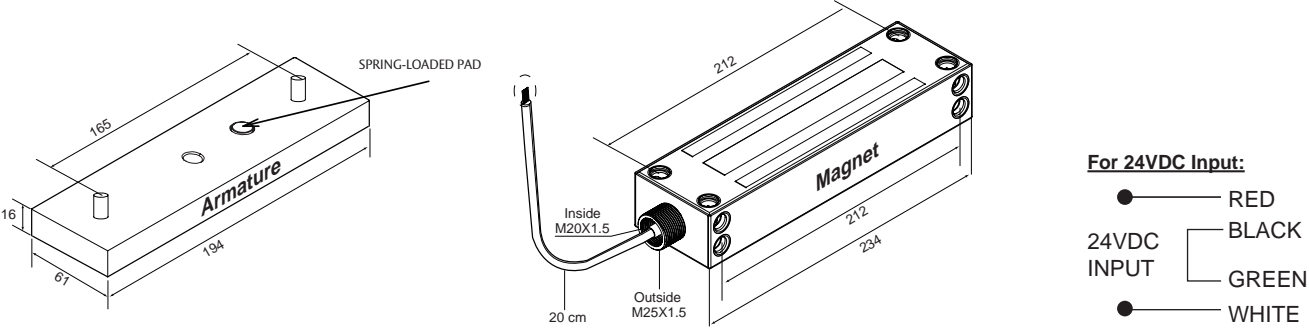

Weather Resistant Series Technical Information

Z8 Weather Resistant Electromagnet	
Holding Force	550KG - 580KG
Dimensions	(L)230 x (H)67 x (D)43 mm
Voltage	12Vdc/ 24Vdc $\pm 10\%$
Current	512mA @ 12Vdc 256mA @ 24Vdc
Monitoring	Hall-Effect
Operating Temperature	-10 to 55 Degrees
Operating Humidity	0 - 95%

Specification Statement

The Weather Resistant Series Electromagnetic Lock should be constructed in an aluminium case with heavy duty electromagnet. The range only operates in fail safe mode and relies on a secondary lock or battery backup system. In some cases the magnet armature plate pivots to accommodate door drop.

Ordering Information

Product Description	Part Number
Z8 Weather Resistant Electromagnet - Monitored	770600-310

Electromagnetic Lock Accessories

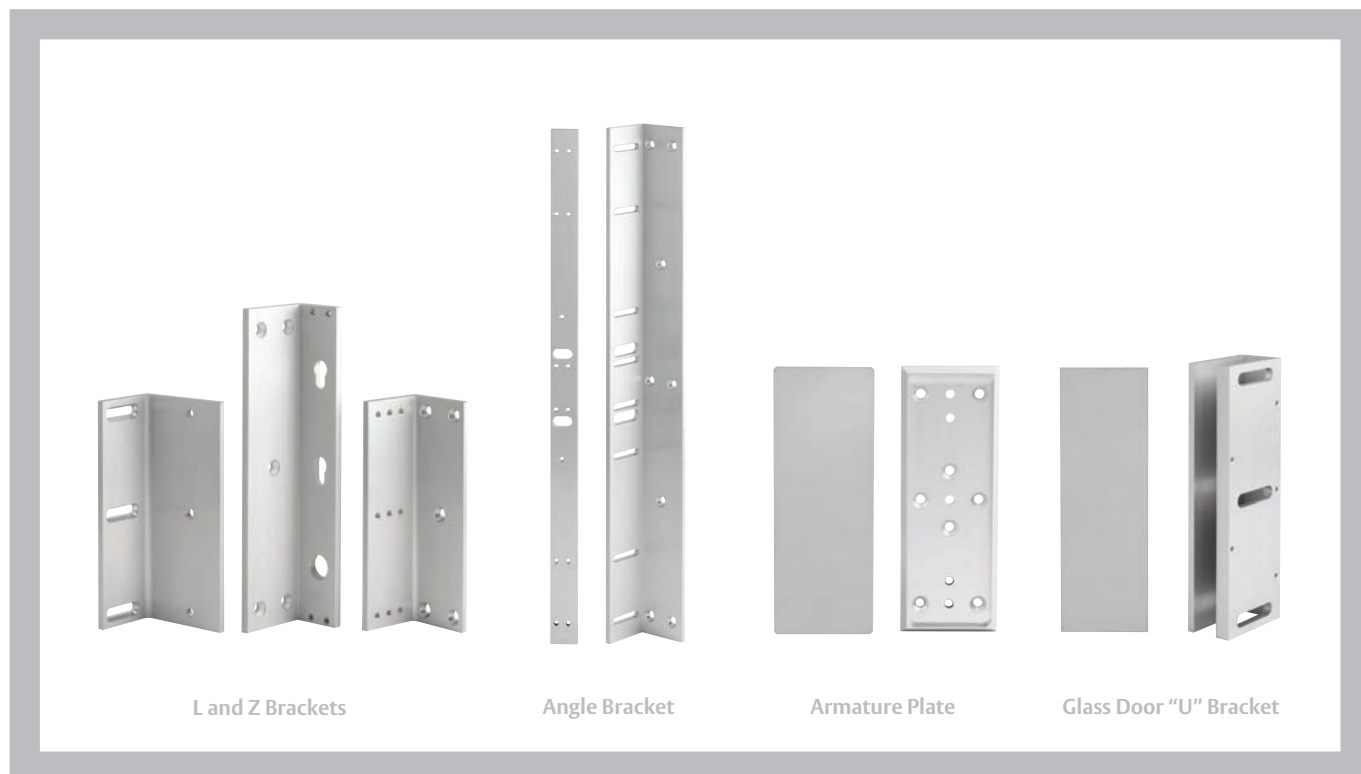

General Description

The PADDE by Lockwood Electromagnetic lock range offers a number of accessory options. These accessories allow the electromagnetic locks to be used in a number of different applications and can be adjusted and suited to each situation. This allows the installer to configure the door as required allowing user specific features such as open in / open out selection or glass door applications. PADDE's Electromagnetic Lock accessories meet or exceed local and international standards, providing safe and secure locking.

Key Features

- Adjustable fixing positions
- Cast aluminium construction
- Meet and exceed International and local standards

Applications

- Open in/Open out doors
- Glass door security
- Double doors security
- Sliding door security

Ordering Information

Product Description	Part Number
L and Z Brackets	
Z4	770300-901
Z4 Double	770300-902
Z8	770600-901
Z8 Double	770600-902
Adjustable Angle Bracket	
Z4	770300-903
Z4 Double	770300-904
Z8	770600-903
Z8 Double	770600-904
Glass Door Armature Plate	
Z4	770300-908
Z8	770600-908
Glass Door "U" Bracket	
Z4	770300-905
Z8	770600-905
Armature and Mounting Brackets	
Z4 Armature Plate	770300-909
Z4 Armature Plate Monitored	770300-910
Z4 Single Mounting Plate	770300-911
Z4 Double Mounting Plate	770300-912
Z8 Armature Plate	770600-956
Z8 Armature Plate Monitored	770600-955
Z8 Double Mounting Plate	770600-951
Z8 Single Mounting Plate	770600-952



Wall Mounted Hold Open Magnet

General Description

This German manufactured wall hold open magnet offers noiseless operation and special retrofit advantages. They also present an excellent additional form of locking. The outstanding feature of the PADDE by Lockwood magnets is the high quality surface and attractive design. These Hold Open Magnets are an integral part of many fire door systems creating peace of mind.

Features

- Fail-safe: unlocks when power is removed
- Easy installation: suitable for both new and retrofit usage
- High holding force: refer to the technical data below
- Silent operation: no humming or buzzing
- Available in 12 or 24Vdc
- Concealed connection terminal

Applications

- Suitable for Fire Doors
- Wall mounted applications
- Both new and retrofit compatible

Standards and Compliance	
	CE Approved
	C-Tick Certified

EF838A Technical Information	
Holding Force	82 kg
Dimensions	(L)93 x (W)65 x (D)38 mm
Voltage	24Vdc
Current	90mA
Monitoring	None
Operating Temperature	0 to 50 Degrees

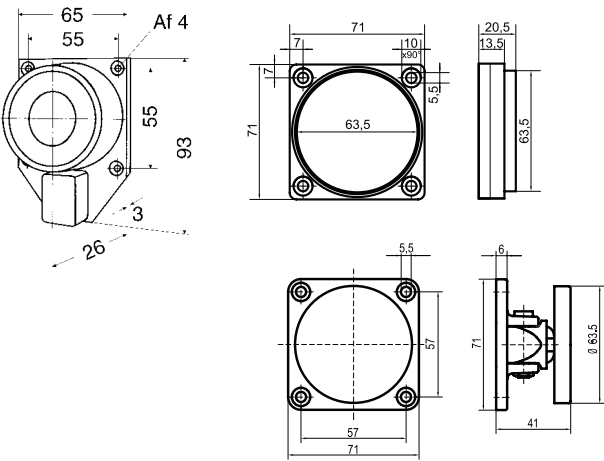

Ordering Information

Product Description	Part Number
EF838A 24Vdc Wall Mounted Hold Open Magnet	151042-000
EF838-2 Counter Holding Plate	151043-000
EF838-3 Pivot Holding Plate	151043-010

Wall and Floor Mounted Hold Open Magnet

General Description

This German manufactured floor and wall hold open magnet offers noiseless operation and special retrofit advantages. They also present an excellent additional form of locking. The outstanding feature of the PADDE by Lockwood magnets is the high quality surface and attractive design. These Hold Open Magnets are an integral part of many fire door systems creating peace of mind.

Features

- Fail-safe: unlocks when power is removed
- Easy installation: suitable for both new and retrofit usage
- High holding force: refer to the technical data below
- Silent operation: no humming or buzzing
- Concealed connection terminal

Applications

- Suitable for Fire Doors
- Floor mounted applications
- Both new and retrofit compatible

Standards and Compliance

-  CE Approved
 C-Tick Certified

EF838WF Technical Information

Holding Force	82 kg
Dimensions	(L)93 x (W)65 x (D)38 mm
Wall spacing	167mm
Floor Spacing	110mm
Current	90mA
Monitoring	None
Operating Temperature	0 to 50 Degrees

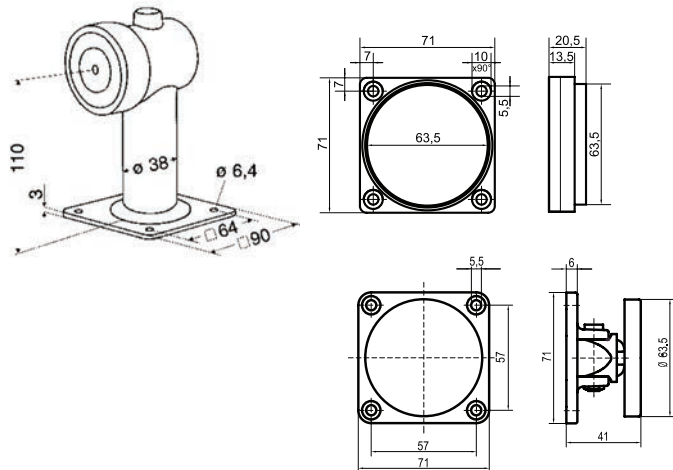

Ordering Information

Product Description

EF838WF 24 Vdc Wall and Floor Mounted Hold Open Magnet
EF838-2 Counter Holding Plate
EF838-3 Pivot Holding Plate

Part Number

151042-100
151043-000
151043-010



ASSA ABLOY is the global leader in door opening solutions, dedicated to satisfying end-user needs for security, safety and convenience.

ASSA ABLOY is represented in all major regions, in both mature and emerging markets, with leading positions in Australia, Europe and North America.

As the world's leading lock group, ASSA ABLOY offers a more complete product range of door opening solutions than any other company on the market.

ASSA ABLOY

Head Office

ASSA ABLOY Australia Pty Limited
235 Huntingdale Road, Oakleigh
Victoria, 3166 Australia

1300 LOCK UP (1300 562 587)
info.au@assaabloy.com
assaabloy.com.au

